



**SPOKANE TRANSIT  
1230 W. BOONE AVENUE  
SPOKANE, WA 99201**

**CONTRACT SPECIFICATIONS  
ROUTE 7 HPT - PHASE 2  
CONTRACT #2025-11135**

**APPENDIX A  
HPT MARKER  
INSTALLATION**



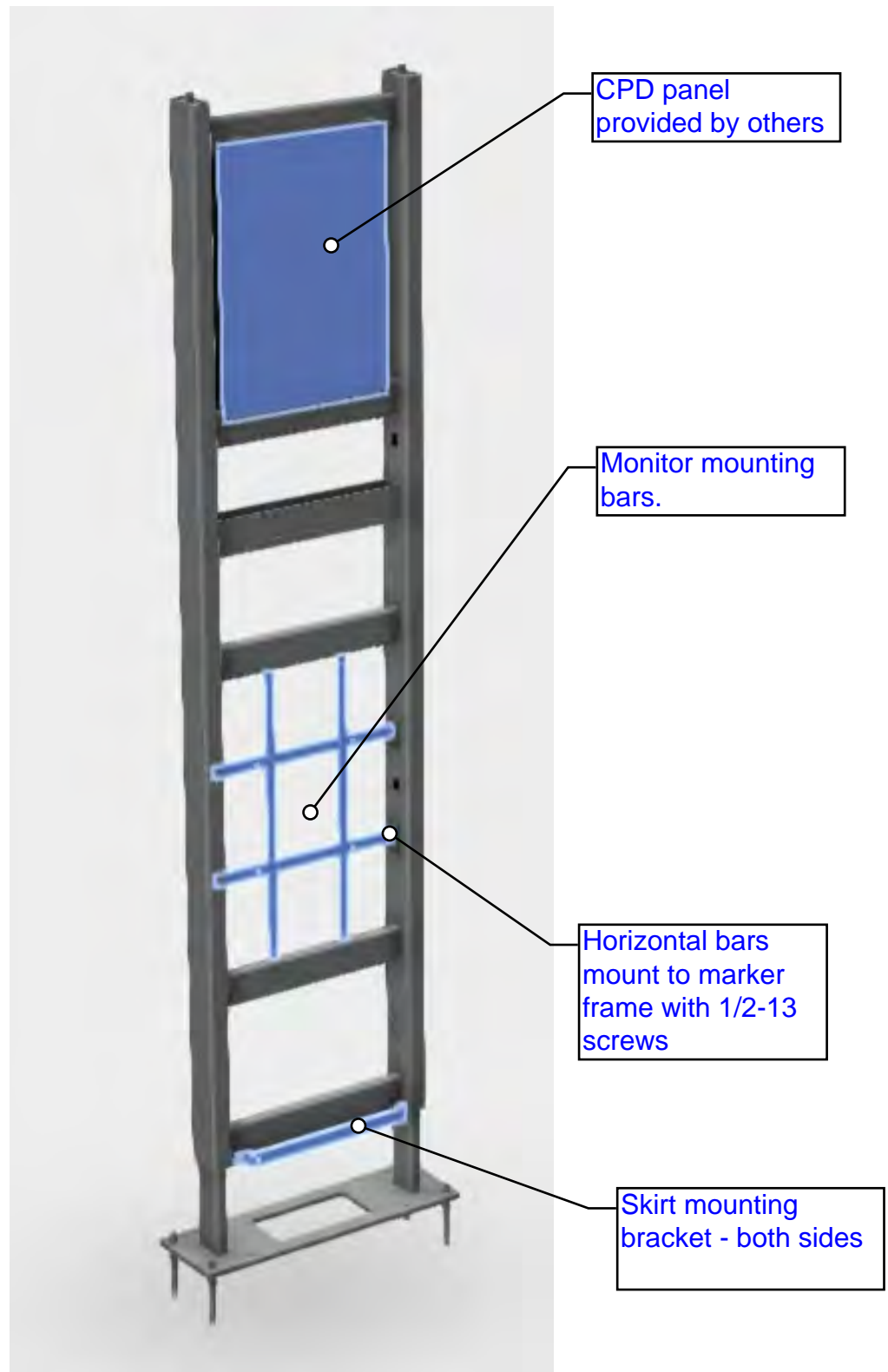

1. Install Skirt mounting brackets using 1/4-20 SS screws
2. Install Monitor mounting bars using 1/2-13 zinc plated hex head screws
3. Install CPD Lighting panels - provided by others



1. Install plastic logos and lettering into cladding panels after they have been vinyl wrapped and before installing them on the marker frame.
2. Seal with clear silicone the backside of logo and lettering on all edges.



1. Map case door will arrive fully assemble less the hinges that affix it to the cladding panel it rests in.
2. After cladding panel has been vinyl wrapped install map case door assembly this may be better suited to do in a shop.
3. Multiple hands will be needed to affix door assembly to cladding panel.
4. The large hinges will need to be positioned loose and slipped together prior to be final mounted to cladding panel and door frame.
5. Look at print set for further assembly instructions.



1. Starting at the bottom install both marker skirt panels with 3 flat head 1/4-20 security screws.
2. If gasket is required to block internal light for escaping at seems apply the supplied gasket on all top and bottom edges of cladding.
3. with multiple people lift and place both sides of bottom cladding.
4. Fit outer two end plastic panels and secure all with pig nose fasteners
5. Use a 1/4-20 threaded rod piece to temporarily hold panels in place if needed the plastic end panels could slide over these rods and they could be removed after a few fasteners are holding everything in place



2 piece construction



Cladding gets screwed together 2 places

1. Continue cladding installation up the marker.
2. NOTE: The cladding that wraps around the marker to canopy connection has changed from prototype. it is now a two piece design this will have to be the next step to put together after the lower panels have been installed. These two panels will have to get fastened together inside the marker prior to putting up any other higher cladding panels.
3. Place all upper panels and again secure in place with pig nose screws through plastic end panels. Leave very two top holes empty for mounting the top cap.



1. Install vent caps in both ends of top cap
2. Lift and slide down top cap with mounting strips behind plastic end panels
3. Secure in place with pig nose hardware.



1. Hang sign, mounting holes will be in canopy sections for this connection.





**SPOKANE TRANSIT  
1230 W. BOONE AVENUE  
SPOKANE, WA 99201**

**CONTRACT SPECIFICATIONS  
ROUTE 7 HPT - PHASE 2  
CONTRACT #2025-11135**

**APPENDIX B  
PEDESTRIAN LIGHT POLES**



**IF IN DOUBT ASK**

SELUX LED LIGHT FIXTURE/  
MOUNTING BRACKET TO BE  
SUPPLIED BY OTHERS.

( - FSI IS ONLY PROVIDING  
DRILLED AND TAPPED HOLES FOR  
THE FIXTURE BRACKET BASED OFF  
MANUFACTURERS INSTALL DRAWINGS.

- MODEL IS FOR REPRESENTATION ONLY)

ART BANNERS/ WAYFINDING SIGNS  
TO BE SUPPLIED BY OTHERS. (MODEL  
SHOWN IS FOR REPRESENTATION  
ONLY)

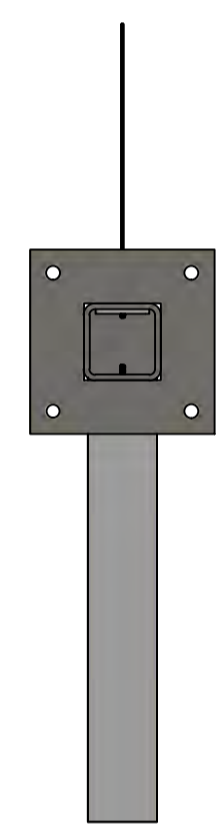
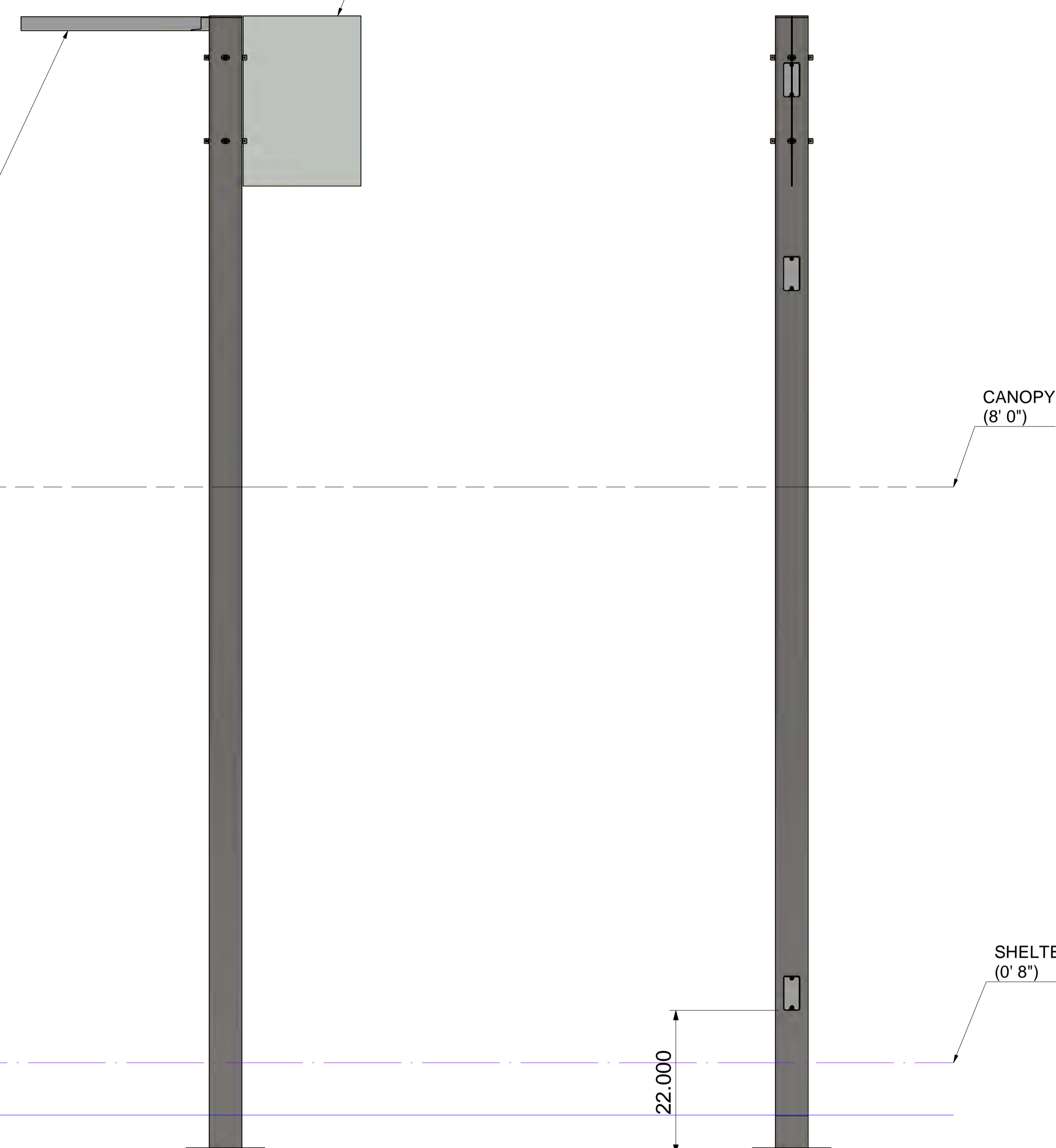
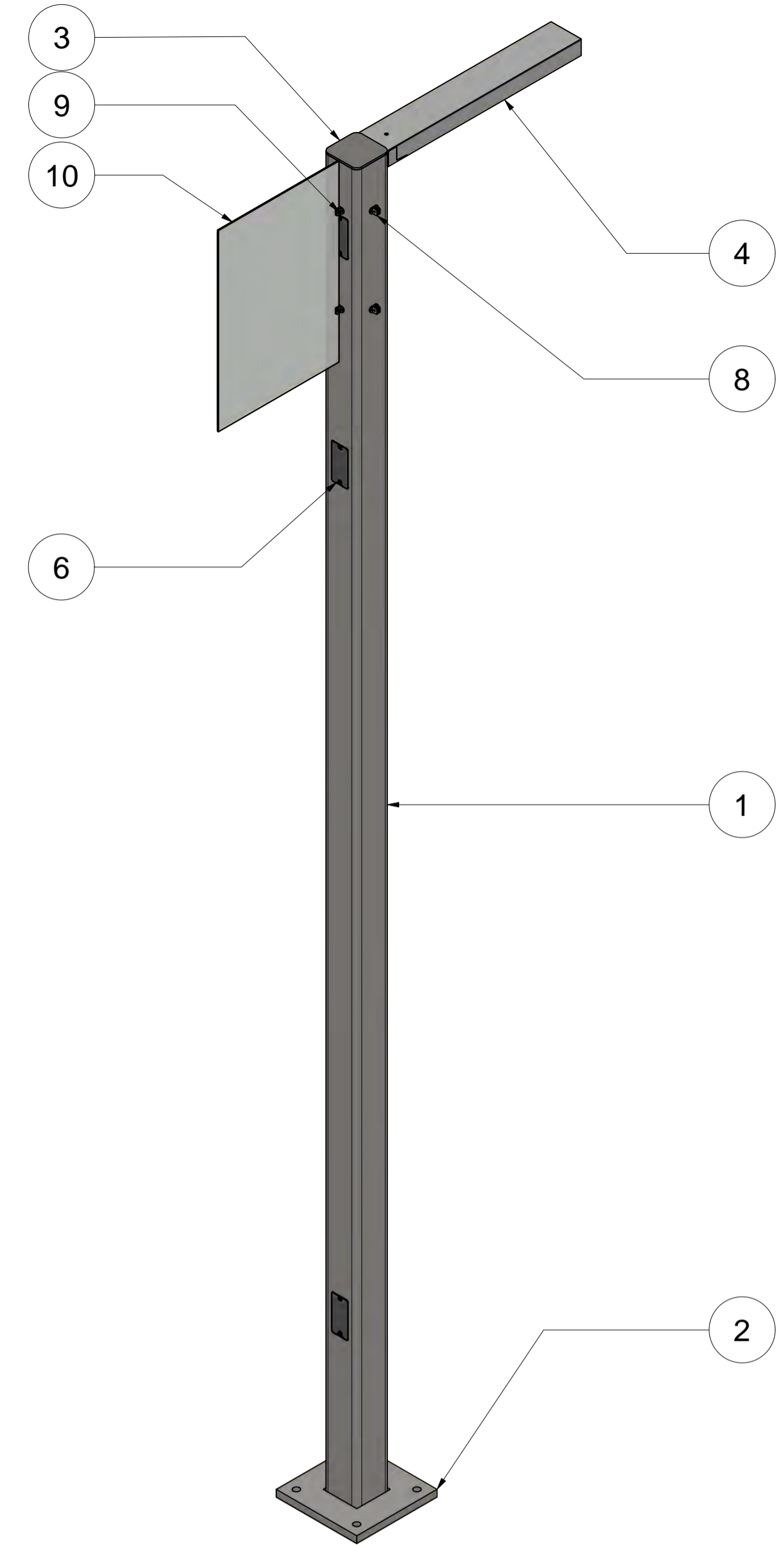

**VIEW A  
BOTTOM VIEW**

PLATFORM  
HORIZONTAL  
DATUM (0,0)

FOUNDATION  
(6" BELOW  
FINISHED FLOOR)

**FINAL ASSEMBLY WITH EQUIPMENT  
PROVIDED BY OTHERS**

**VIEW  
A**

Notes: Remove all sharp edges and burrs unless otherwise stated.

Material: HSS Steel, A36 Steel Plate

Finish: Assemblies to be galvanized and to be painted to client specifications

Weight: N/A

Assemblies Required: 4

Tolerances unless stated otherwise to be at  $\pm 1/32"$

**PARTS LIST**

ITEM	QTY	DRAWING NUMBER	DESCRIPTION
1	1.000 in	AISC HSS - 5 x 5 x 3/8	SEE SHEET 3 AND 4
2	2	Light Post Base Plate	SEE SHEET 5
3	2	Light Post Top Cap	SEE SHEET 6
4	2	Arca Light Representation Model (Selux)	Supplied By Others
5	3	Handhole Cover Mount	SEE SHEET 7
6	6	Handhole Cover Plate	SEE SHEET 8
7	12	1-4 UNC x 1 TAMPER-RESISTANT TORX FLAT HEAD SCREWS	91870A752
8	14	Removable Banner Clamp	REF DWG # FSI-08-30-001
9	12	ANSI B18.3 - 10 - 24 x 3/4 (Item 5 - Removable Banner Clamp)	Hexagon Socket Button Head Cap Screw
10	2	Banner	Supplied By Others
11	1	WELD STUDS	93865A235

0	CC	2021-12-03	FOR FABRICATION/ APPROVAL
REV	DESIGNER	Date	REV DETAILS



All dimensions in inches,  
Do not manually alter  
CAD drawings,  
Do not scale

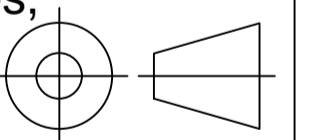

Client **Spokane Transit**  
Property of STA

Title  
**PEDESTRIAN LIGHT 1  
SINGLE LED DETAILS**

Scale **NTS** Date **2021-03-14**

Drawn **CC** Page **1 OF 7**

Drawing No. **FSI-08-00-008** Rev **0**

IF IN DOUBT ASK

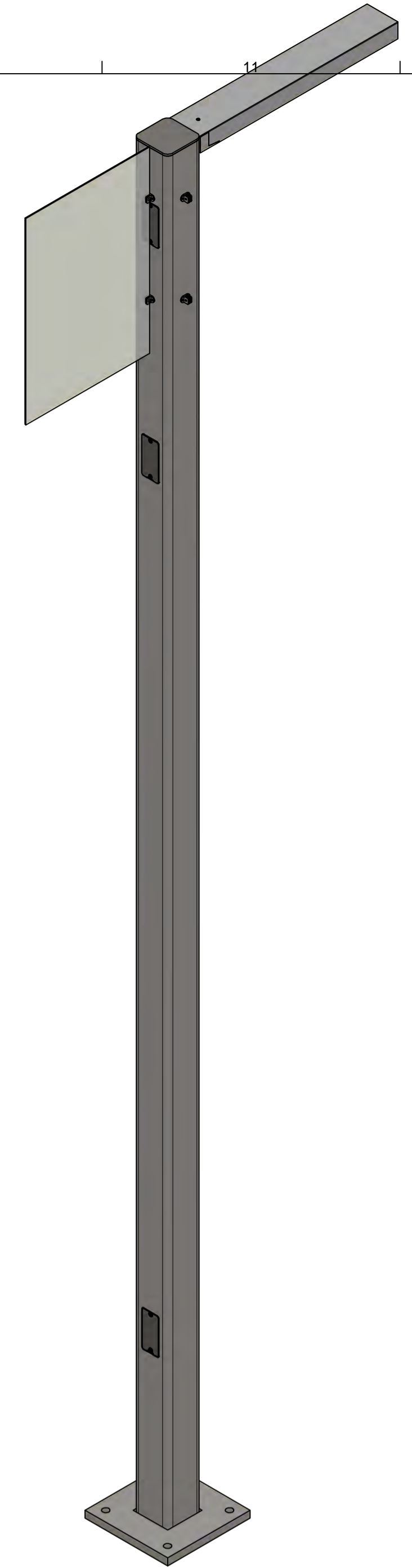
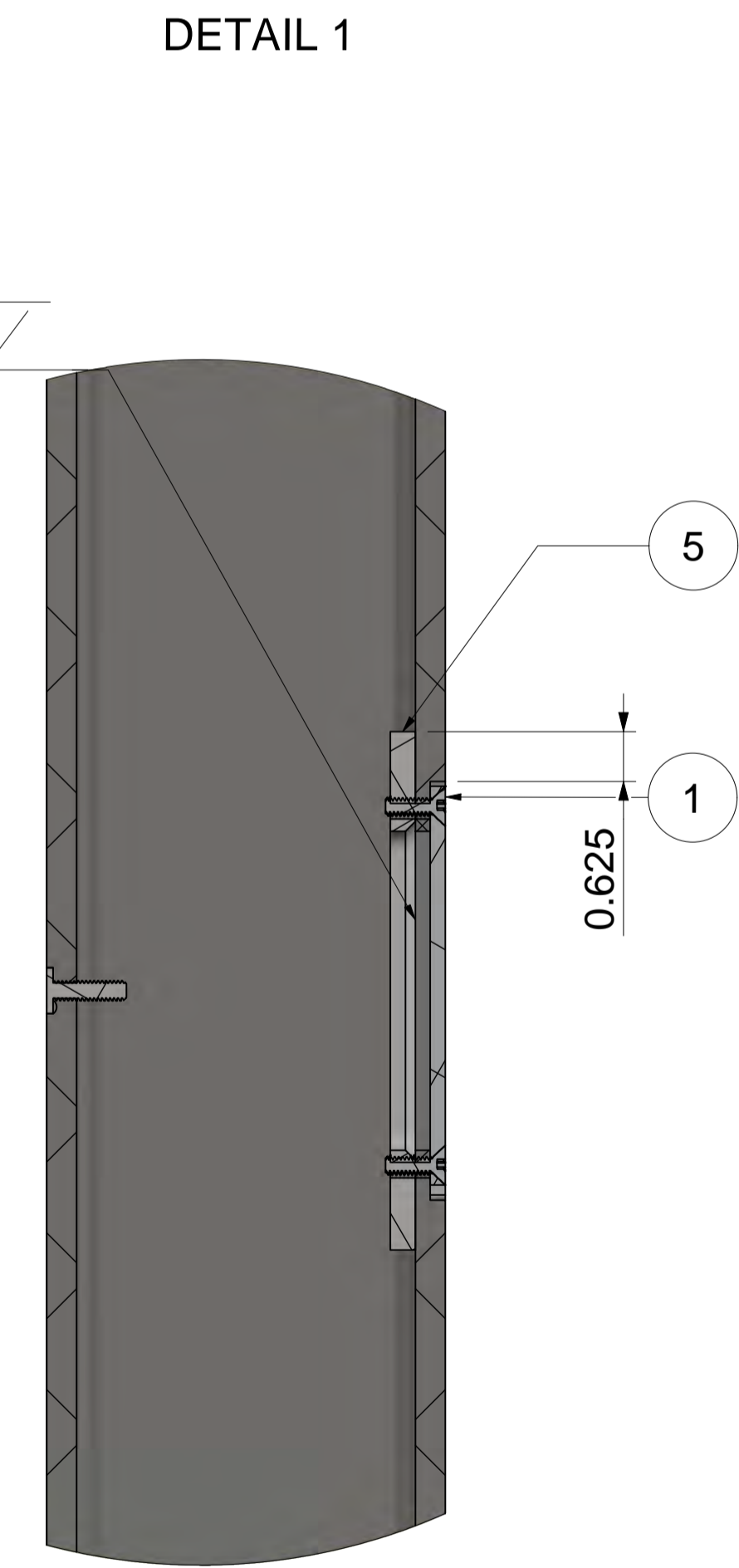
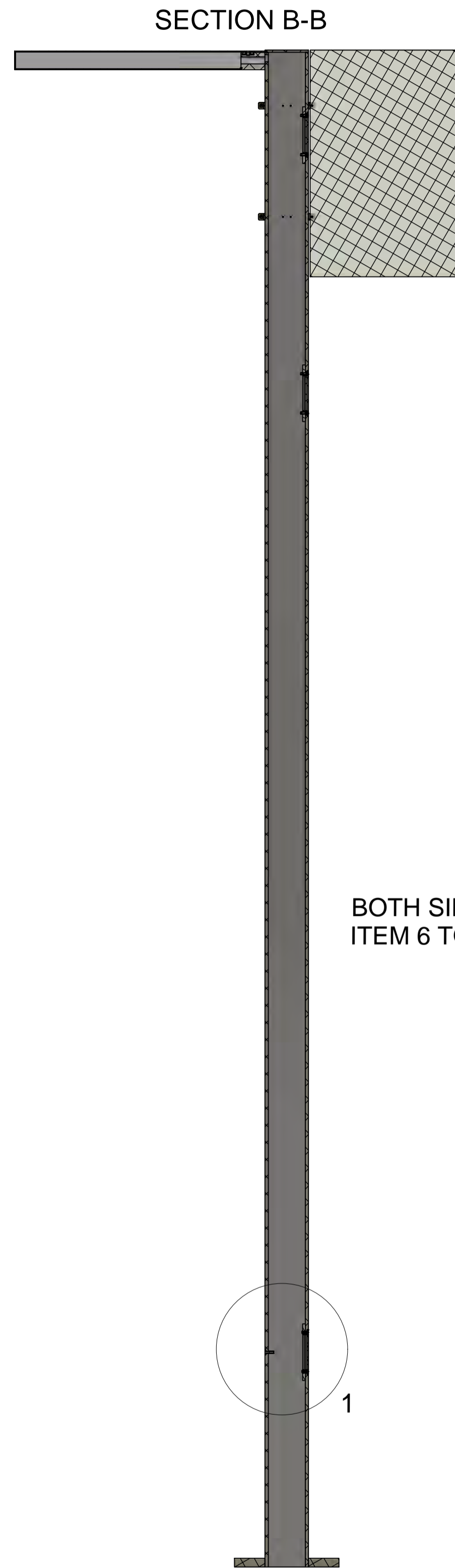
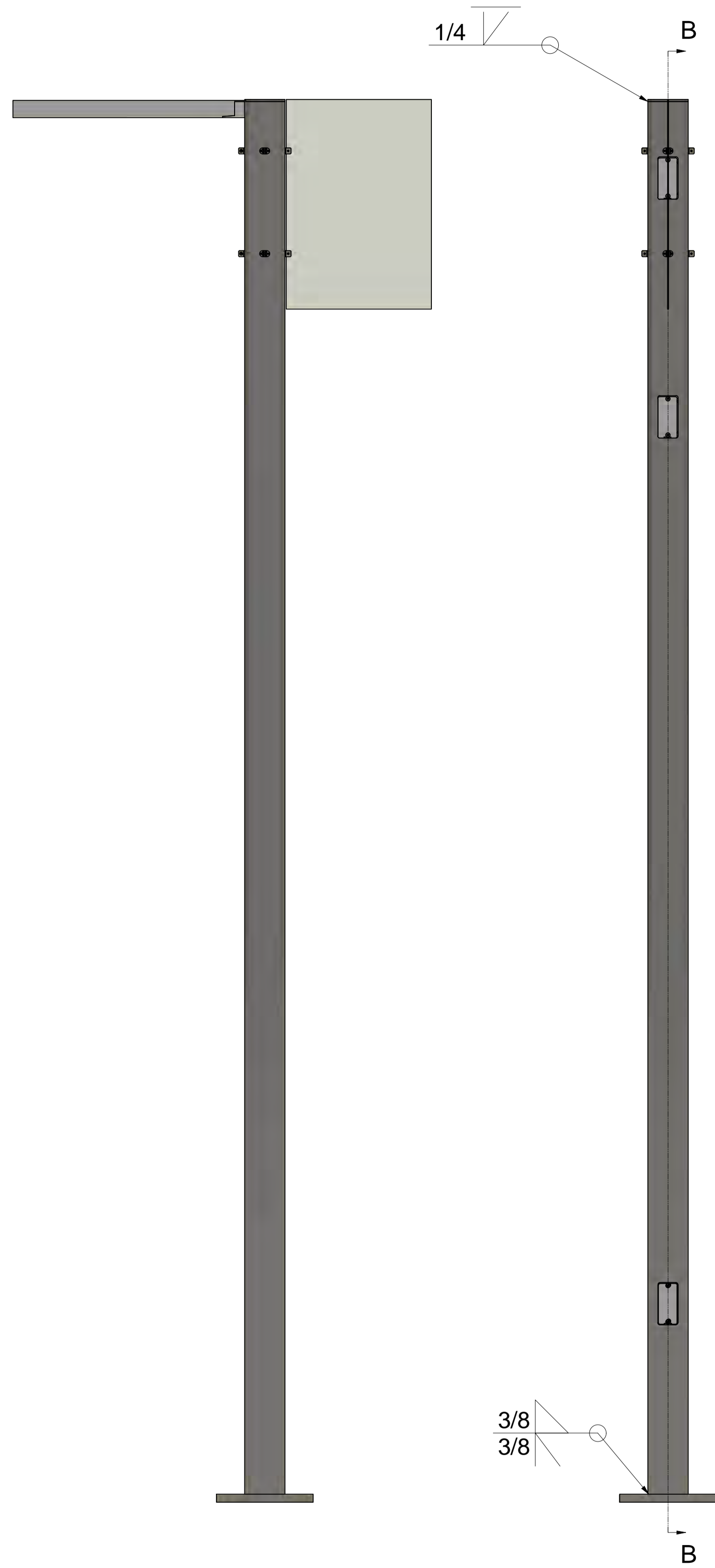

FINAL ASSEMBLY PROVIDED BY FUTURE SYSTEM INC.

All dimensions in inches, Do not manually alter CAD drawings, Do not scale	
Client <b>Spokane Transit</b> Property of STA	
Title <b>PEDESTRIAN LIGHT 1          SINGLE LED DETAILS</b>	
Scale	Date
NTS	2021-03-14
Drawn	Page
CC	2 OF 7
Drawing No.	Rev
FSI-08-00-008	0

**IF IN DOUBT ASK**

**RIGHT SIDE VIEW**

ITEM: 1 - AISC HSS - 5 x 5 x 3/8 - 173.75

QTY PER ASSEMBLY: 1

MATERIAL: A500C HSS TUBE

APPROX.WEIGHT: 145kgs (320lbs)

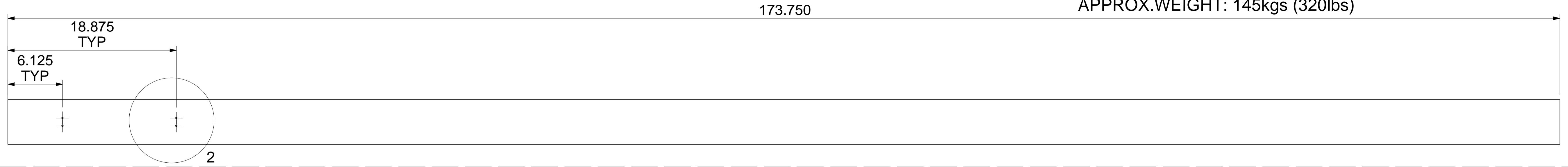

**REAR VIEW**

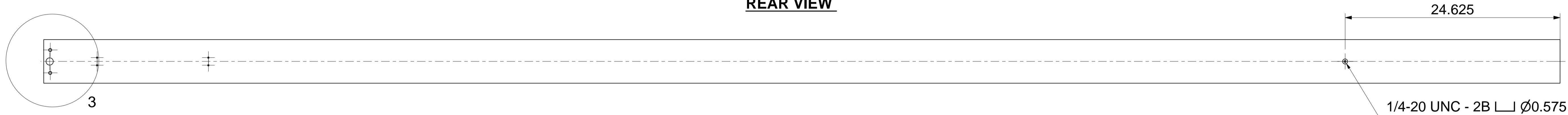

**LEFT SIDE VIEW**

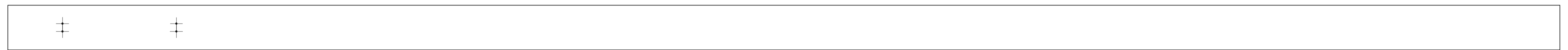

**FRONT VIEW**

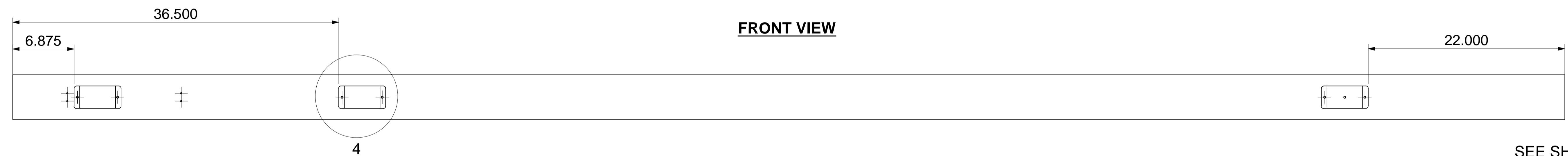

SEE SHEET 4 FOR VIEW C

10-24 UNC - 2B  
TYP ALL  
BANNER CLAMPS

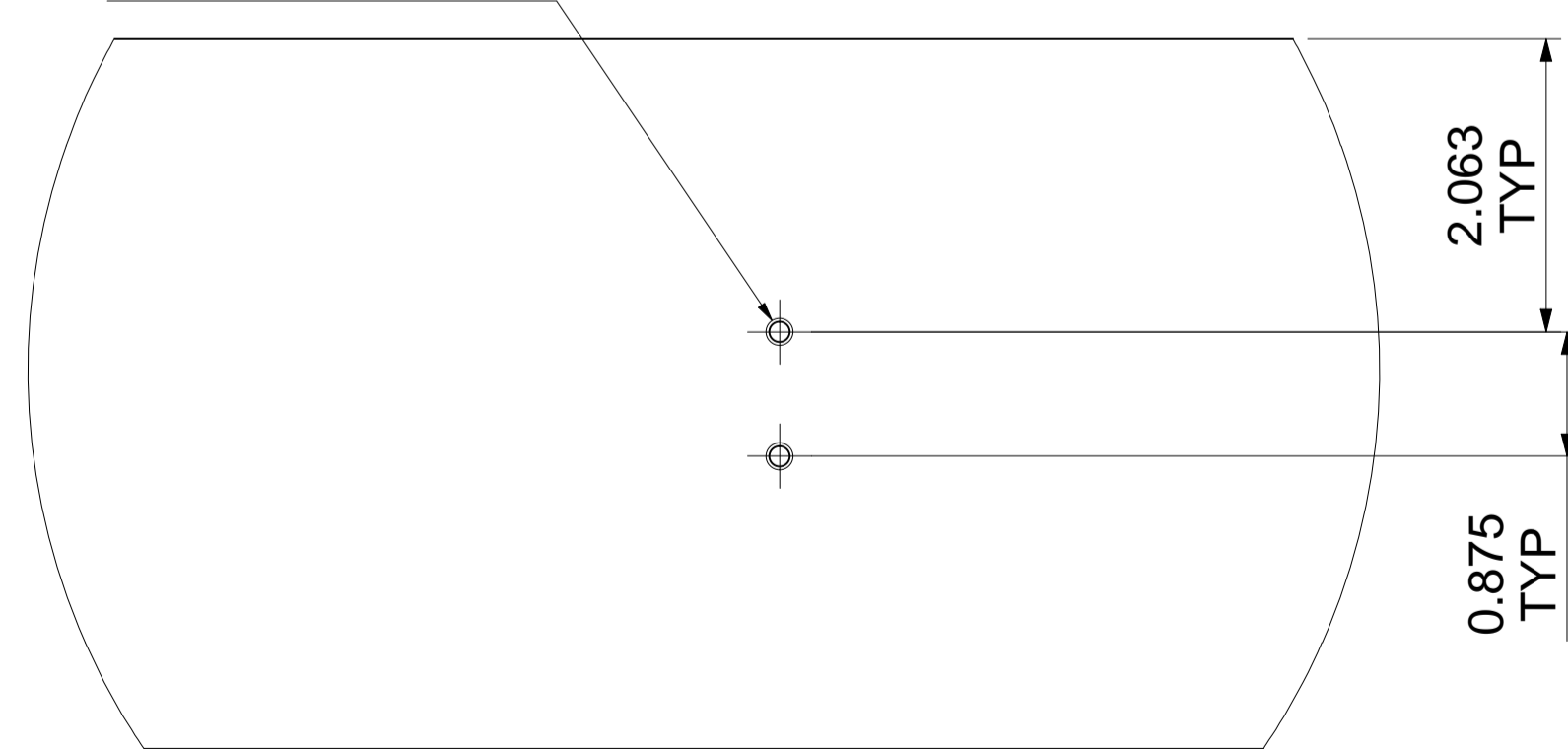

**DETAIL 2  
TYPICAL BANNER  
CLAMP HOLE DETAIL**

0.750  
TYP  
M10x1.5 - 6H  
TYP

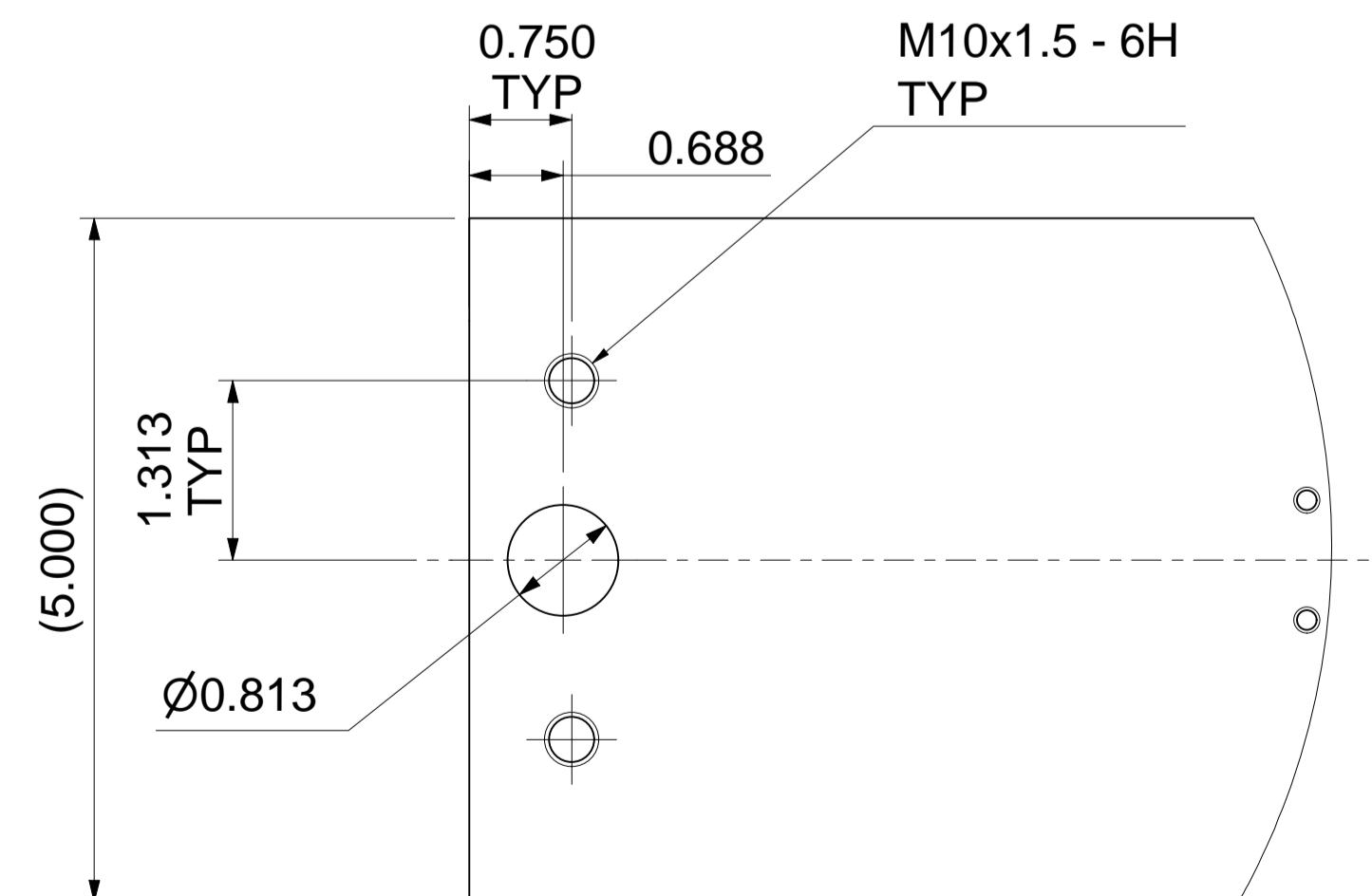

**DETAIL 3  
LIGHT BRACKET  
MOUNTING DETAILS**

**SECTION C-C**

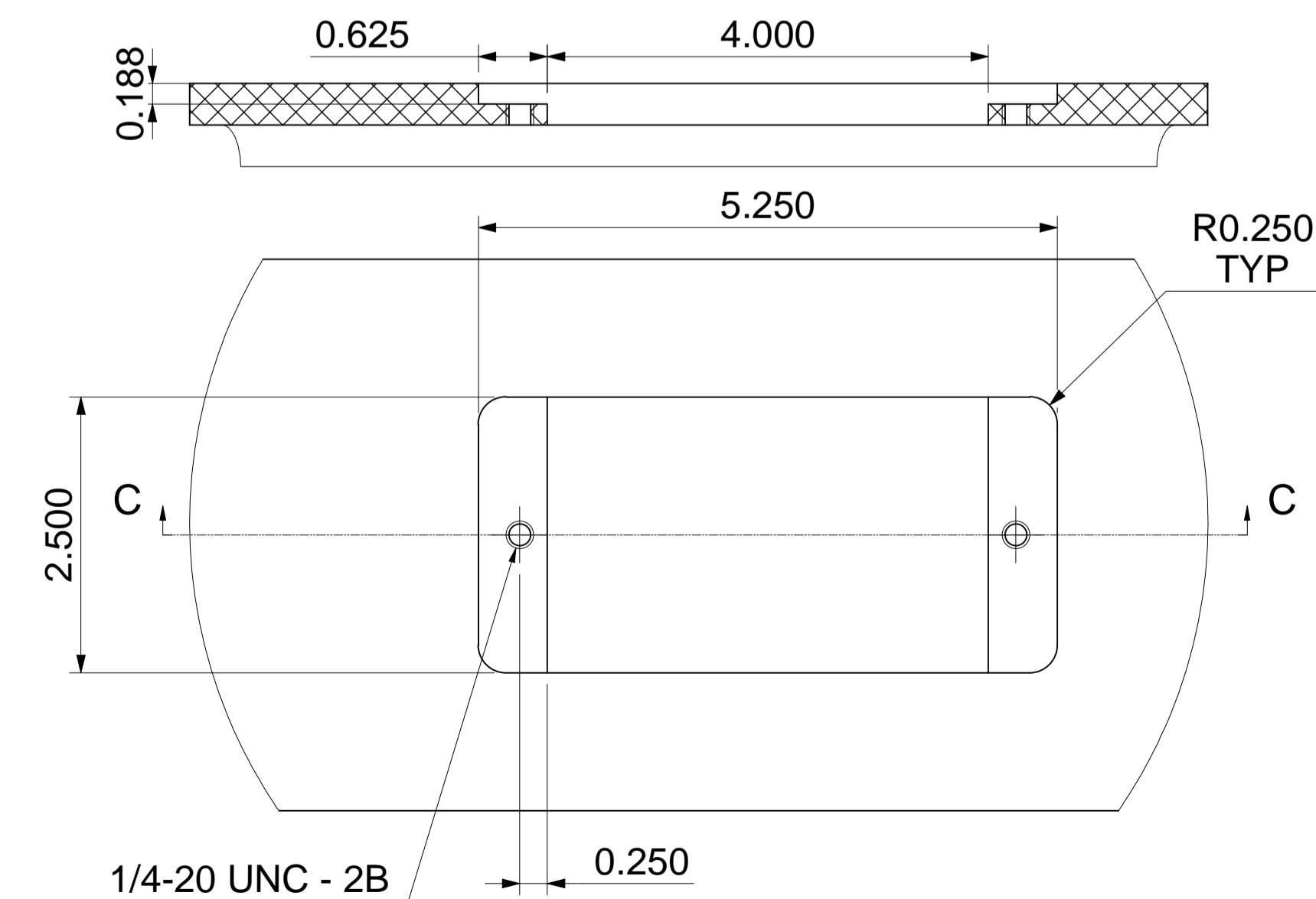

**DETAIL 4  
TYPICAL HANDHOLE  
DETAIL**

**future**  
systems inc

All dimensions in inches,  
Do not manually alter  
CAD drawings,  
Do not scale

Client **Spokane Transit**  
Property of STA

Title  
**PEDESTRIAN LIGHT 1  
SINGLE LED DETAILS**

Scale **NTS** Date **2021-03-14**

Drawn **CC** Page **3 OF 7**

Drawing No. **FSI-08-00-008** Rev **0**

IF IN DOUBT ASK

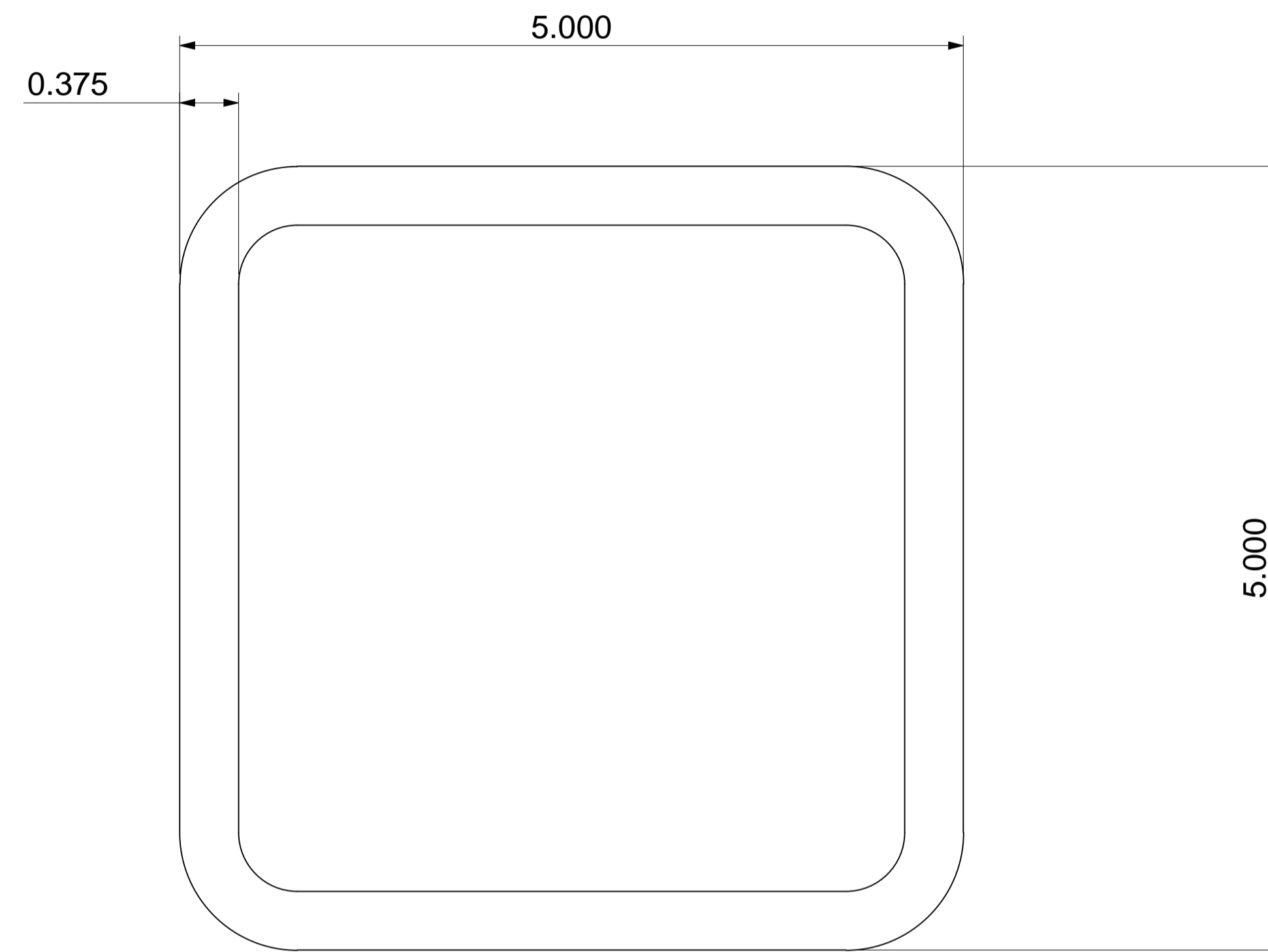

VIEW C



All dimensions in inches,  
Do not manually alter  
CAD drawings,  
Do not scale

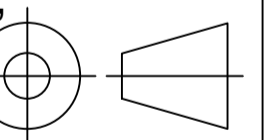

Client **Spokane Transit**  
Property of STA

Title  
PEDESTRIAN LIGHT 1  
SINGLE LED DETAILS

Scale NTS Date 2021-03-14

Drawn CC Page 4 OF 7

Drawing No. FSI-08-00-008 Rev 0

IF IN DOUBT ASK

ITEM: 2 - BASE PLATE 12 x 12 x 1"

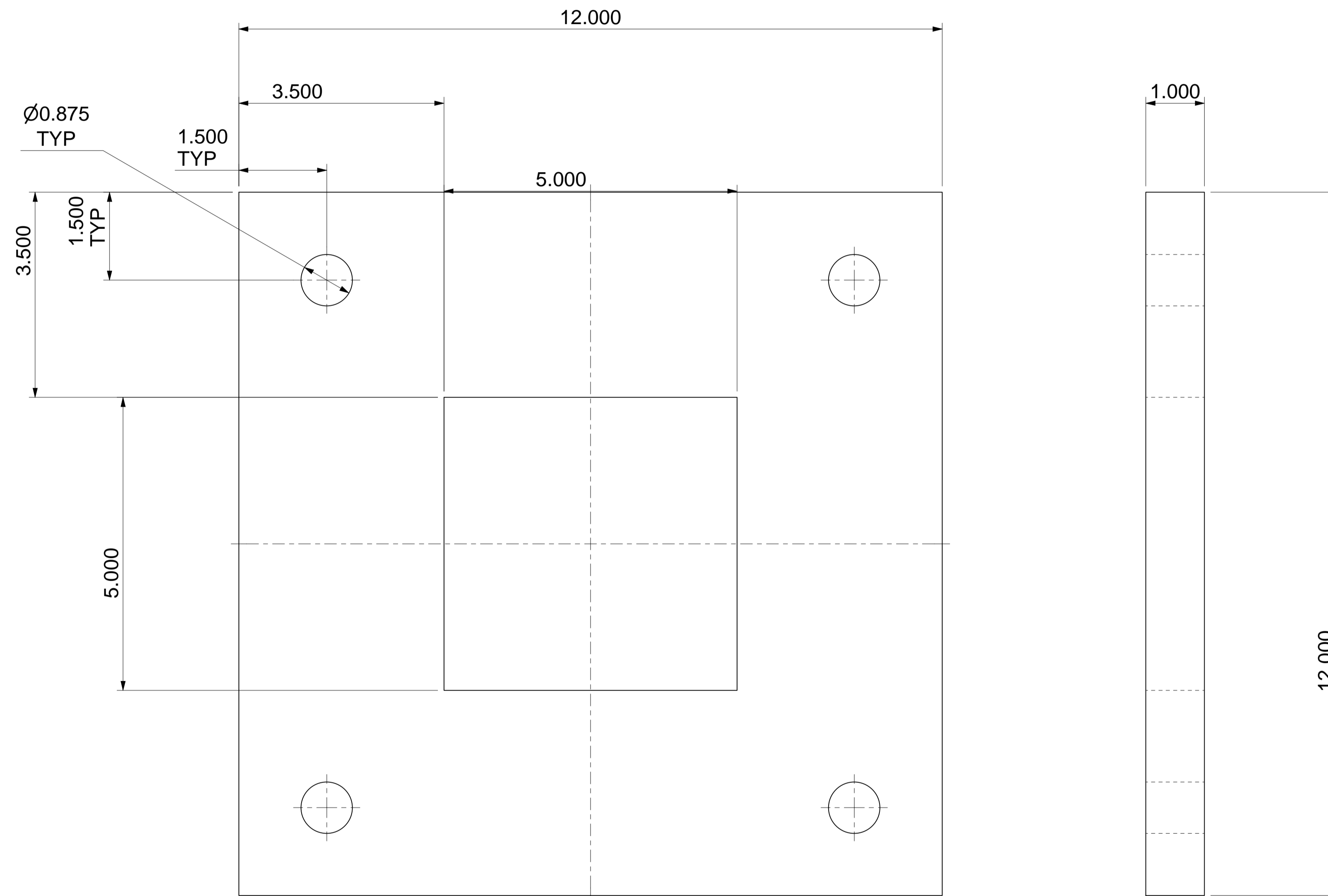

QTY PER ASSEMBLY: 1  
MATERIAL: A36 STEEL PLATE  
APPROX.WEIGHT: 15kgs (33lbs)



All dimensions in inches,  
Do not manually alter  
CAD drawings,  
Do not scale

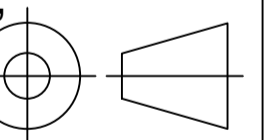

Client **Spokane Transit**  
Property of STA

Title  
PEDESTRIAN LIGHT 1  
SINGLE LED DETAILS

Scale NTS Date 2021-03-14

Drawn CC Page 5 OF 7

Drawing No. FSI-08-00-008 Rev 0

IF IN DOUBT ASK

ITEM: 3 - LIGHT POST TOP CAP

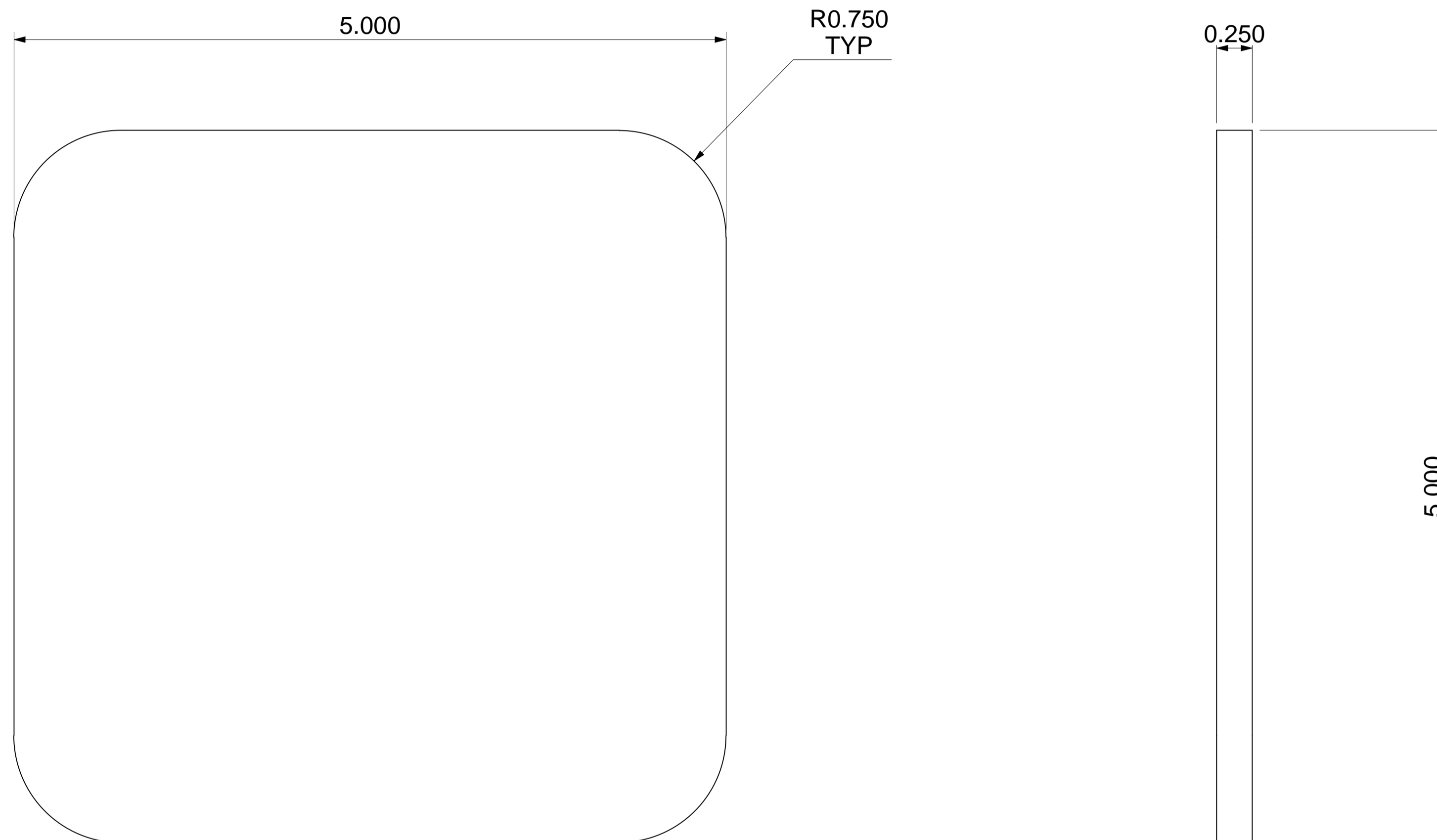

QTY PER ASSEMBLY: 1  
MATERIAL: A36 STEEL PLATE

**future**  
systems inc

All dimensions in inches,  
Do not manually alter  
CAD drawings,  
Do not scale

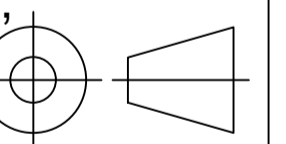

Client **Spokane Transit**  
Property of STA

Title  
PEDESTRIAN LIGHT 1  
SINGLE LED DETAILS

Scale NTS Date 2021-03-14

Drawn CC Page 6 OF 7

Drawing No. FSI-08-00-008 Rev 0

IF IN DOUBT ASK

ITEM: 7 - HAND HOLE COVER PLATE

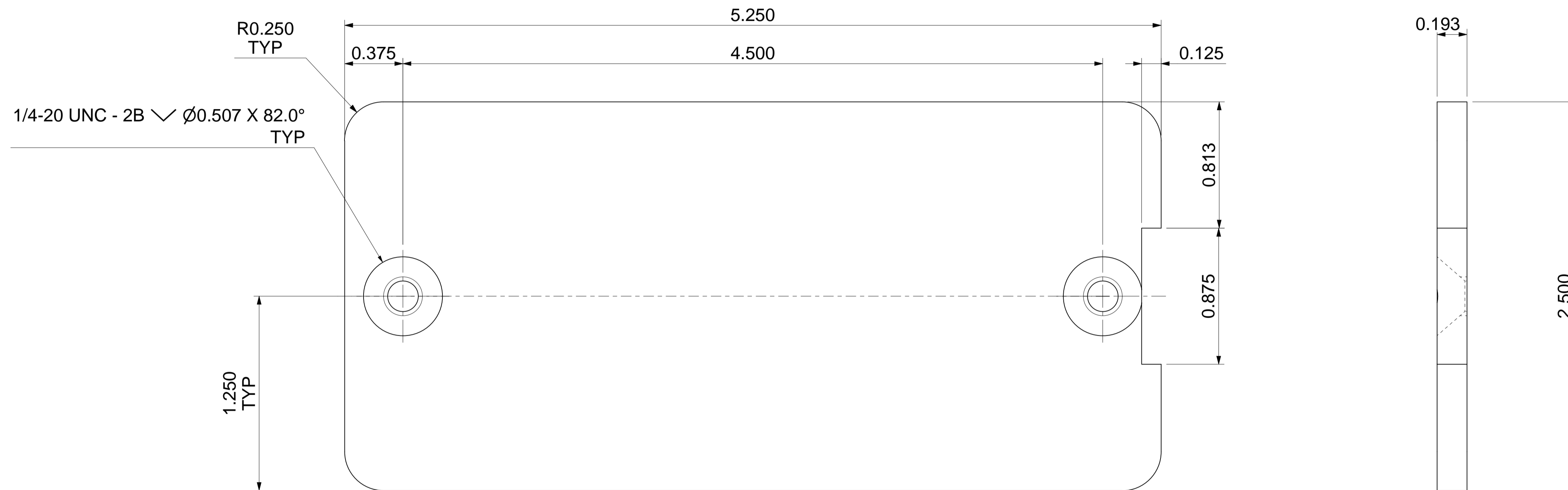

QTY PER ASSEMBLY: 3  
MATERIAL: A36 STEEL PLATE



All dimensions in inches,  
Do not manually alter  
CAD drawings,  
Do not scale

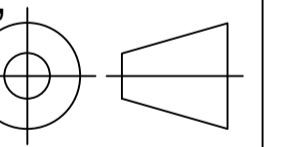

Client **Spokane Transit**  
Property of STA

Title  
PEDESTRIAN LIGHT 1  
SINGLE LED DETAILS

Scale NTS Date 2021-03-14

Drawn CC Page 7 OF 7

Drawing No. FSI-08-00-008 Rev 0



**SPOKANE TRANSIT  
1230 W. BOONE AVENUE  
SPOKANE, WA 99201**

**CONTRACT SPECIFICATIONS  
ROUTE 7 HPT - PHASE 2  
CONTRACT #2025-11135**

**APPENDIX C  
WASTE/RECYCLE BINS**





PRODUCT DESCRIPTION: <b>RECYCLE HOPPER (LOCK MOD)</b>	ITEM NUMBER: * <b>UCS-2422L</b>	QUOTE DATE: <b>01/13/22</b>	SHEET 1 OF 1
DIMENSIONS: <b>25" x 26.97" x 49.8"</b>	ORDER QUANTITY:	PRICE (BASED ON ORDER QTY)** <b>\$1,195.00</b>	

\*ORDER VIA ITEM NUMBER. DELIVERY and \*\*INSTALLATION CHARGES MAY APPLY

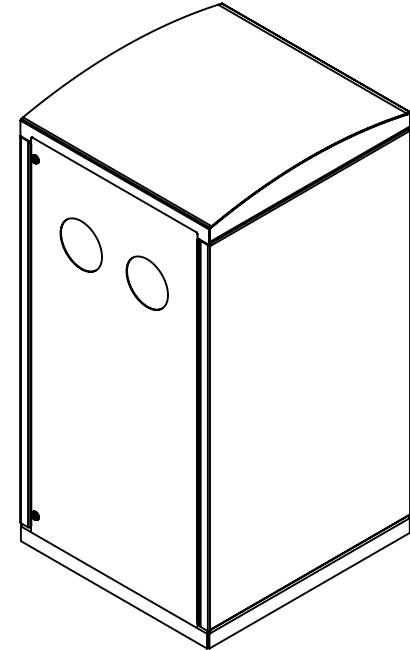
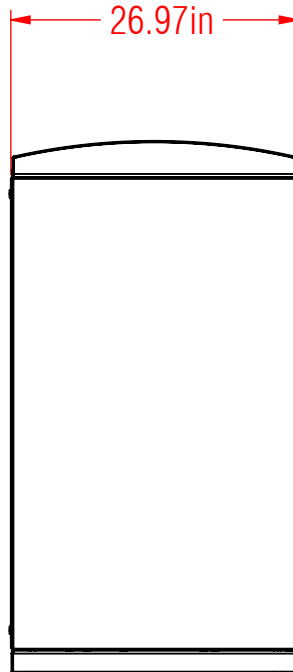
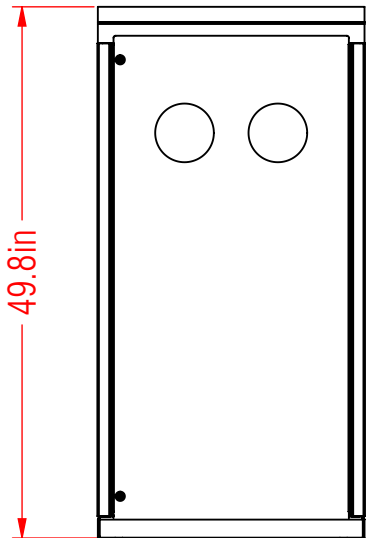
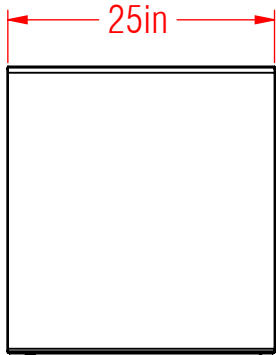

- 1 YEAR WARRANTY
- HEAVY STEEL CONSTRUCTION
- POWDER COAT FINISH
- LOCKING DOOR
- LEVELING FEET

DRAWN BY: <b>C, Self</b>	REVISED BY:	REVISED DATE:	APPROVED BY:	CUSTOMER APPROVAL:	DATE:	AE REVIEWED:
-----------------------------	-------------	---------------	--------------	--------------------	-------	--------------

PRODUCT DESCRIPTION: <b>SPOKANE HOPPER</b>	ITEM NUMBER: * <b>UCS-2422K</b>	QUOTE DATE: <b>01/13/22</b>	SHEET 1 OF 1
DIMENSIONS: <b>25" x 32.02" x 49.8"</b>	ORDER QUANTITY:	PRICE (BASED ON ORDER QTY)** <b>\$1,495.00</b>	

\*ORDER VIA ITEM NUMBER. DELIVERY and \*\*INSTALLATION CHARGES MAY APPLY

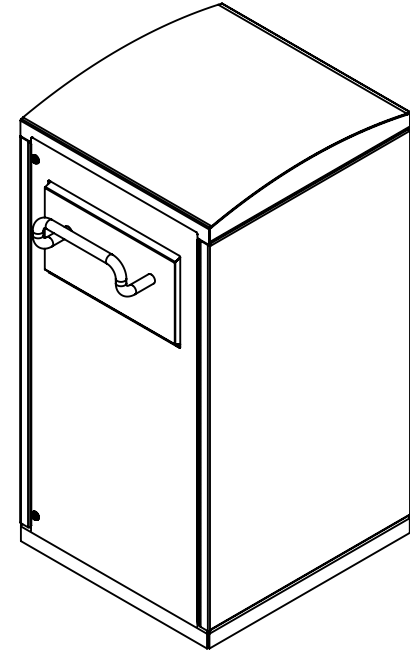
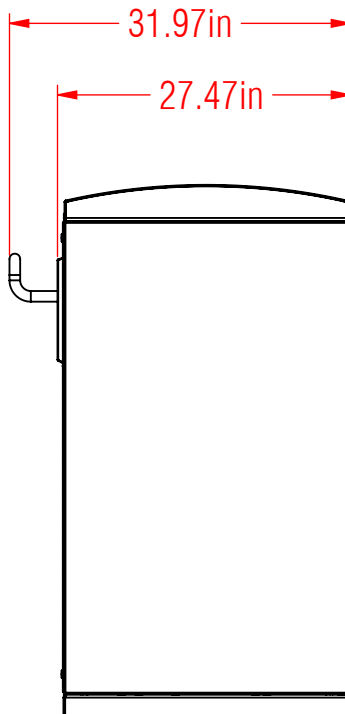
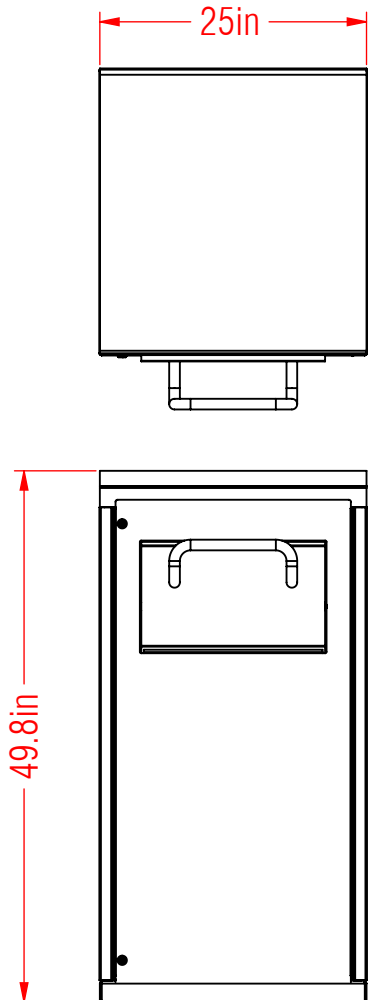

- 1 YEAR WARRANTY
- HEAVY STEEL CONSTRUCTION
- POWDER COAT FINISH
- LOCKING DOOR
- LEVELING FEET

DRAWN BY: <b>C, Self</b>	REVISED BY:	REVISED DATE:	APPROVED BY:	CUSTOMER APPROVAL:	DATE:	AE REVIEWED:
-----------------------------	-------------	---------------	--------------	--------------------	-------	--------------



**SPOKANE TRANSIT  
1230 W. BOONE AVENUE  
SPOKANE, WA 99201**

**CONTRACT SPECIFICATIONS  
ROUTE 7 HPT - PHASE 2  
CONTRACT #2025-11135**

**APPENDIX D  
LEANING RAILS**



REVISIONS			
REV.	DESCRIPTION	DATE	APPROVED
C	4" Tube was 3" Tube, Stainless Steel Tamperproof Anchors by others, 10" Base Plate was 11"	8/5/21	ACC

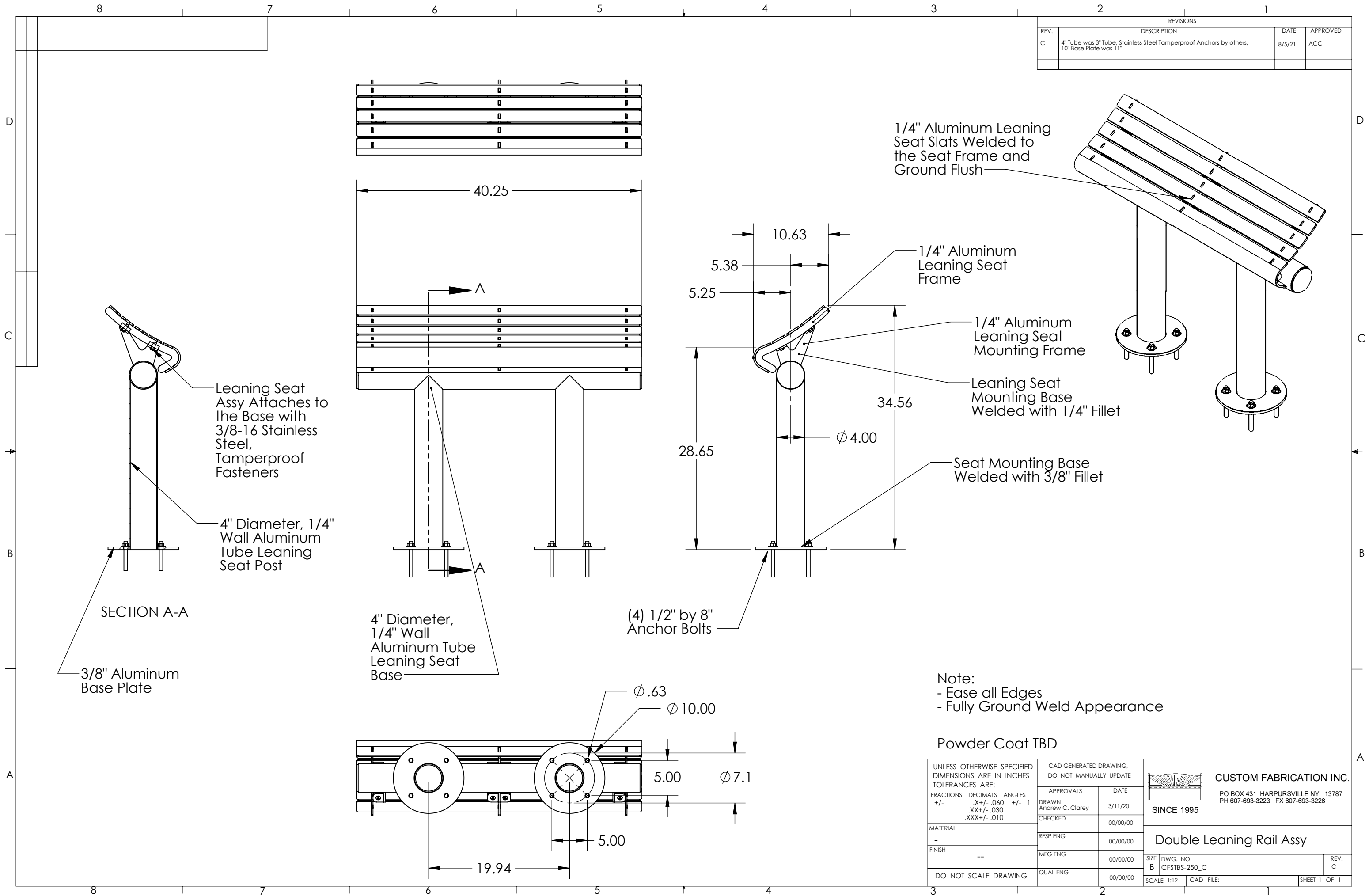

Note:  
 - Ease all Edges  
 - Fully Ground Weld Appearance

Powder Coat TBD

UNLESS OTHERWISE SPECIFIED DIMENSIONS ARE IN INCHES TOLERANCES ARE: FRACTIONS DECIMALS ANGLES +/- .X+/- .060 +/- 1 .XX+/- .030 .XXX+/- .010	CAD GENERATED DRAWING, DO NOT MANUALLY UPDATE		<p><b>CUSTOM FABRICATION INC.</b>        PO BOX 431 HARPURSVILLE NY 13787        PH 607-693-3223 FX 607-693-3226</p>
	APPROVALS	DATE	
	DRAWN Andrew C. Clarey	3/11/20	
	CHECKED	00/00/00	
MATERIAL	RESP ENG	00/00/00	<p><b>Double Leaning Rail Assy</b></p>
FINISH	MFG ENG	00/00/00	
DO NOT SCALE DRAWING	QUAL ENG	00/00/00	
SCALE 1:12		CAD FILE:	SHEET 1 OF 1



**SPOKANE TRANSIT  
1230 W. BOONE AVENUE  
SPOKANE, WA 99201**

**CONTRACT SPECIFICATIONS  
ROUTE 7 HPT - PHASE 2  
CONTRACT #2025-11135**

**APPENDIX E  
CUSTOMER INFORMATION DISPLAYS**



# TAB B

# COMPLIANCE WITH SPECIFICATIONS

